

GT1600D

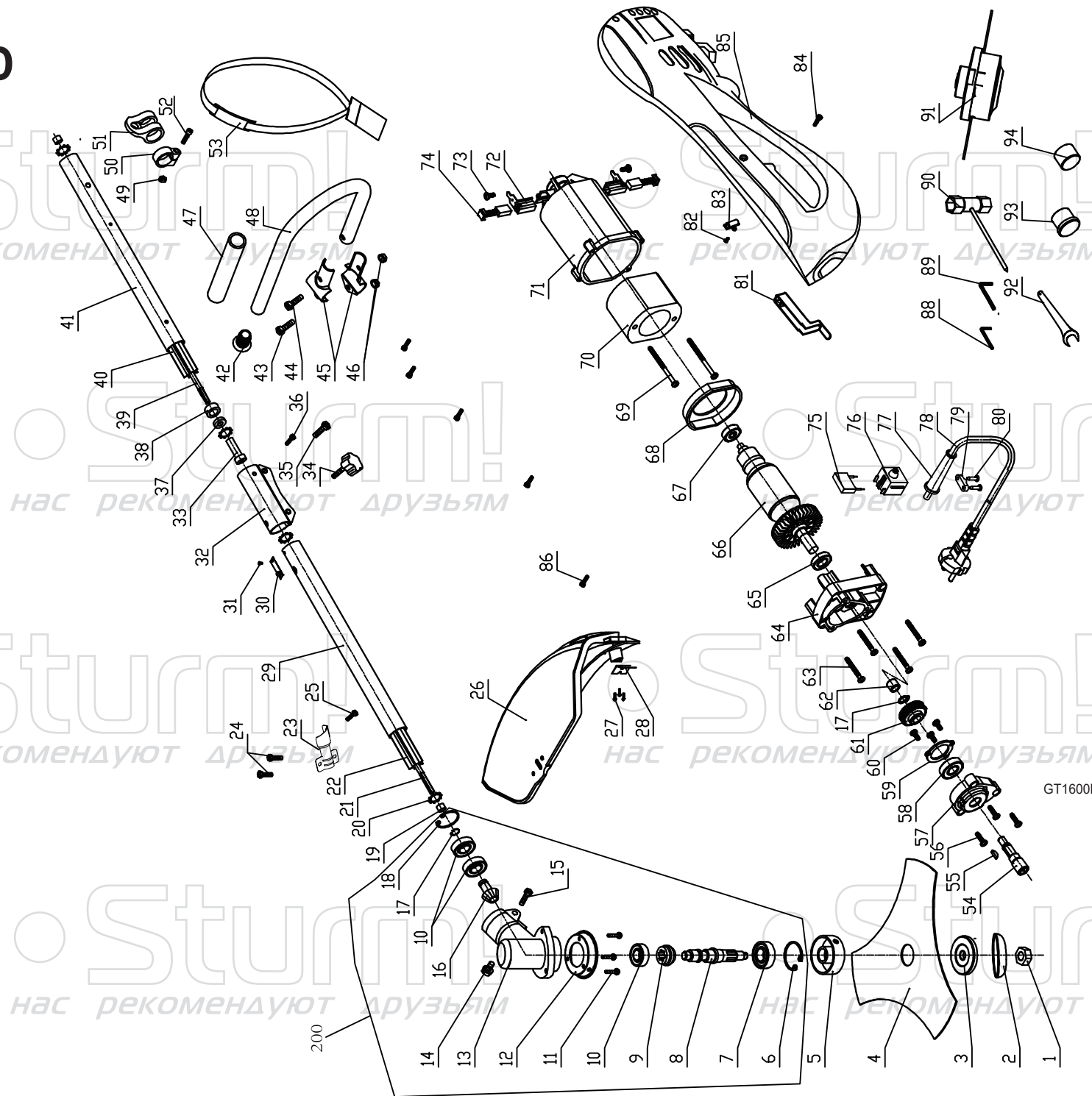

GT1600D-EX-RUS220908

GT1600D

| NO. | DESCRIPTION | NO. | DESCRIPTION | NO. | DESCRIPTION |
|-----|--------------------------|-----|-----------------------|-----|----------------------|
| 1 | left-NUT M10 | 33 | soft shaft bush | 65 | bearing 6901Z |
| 2 | The blade cover | 34 | locking knob | 66 | rotor |
| 3 | down flange | 35 | screw M6*20 | 67 | bearing 627Z |
| 4 | blade | 36 | screw M4*10 | 68 | wind guide |
| 5 | upper flange | 37 | Retaining ring | 69 | Tapping screw ST5*60 |
| 6 | circlip \varnothing 32 | 38 | screw bush | 70 | stator |
| 7 | bearing 6002Z | 39 | soft shaft B | 71 | motor housing |
| 8 | spindle | 40 | plastic tube B | 72 | carbon brush holder |
| 9 | big gear | 41 | steel tube B | 73 | Tapping screw ST3*8 |
| 10 | bearing 6000Z | 42 | Rubber plug | 74 | carbon brush |
| 11 | screwM5*12 | 43 | screw M6*15 | 75 | capacitor |
| 12 | gear box cover | 44 | screw M6*25 | 76 | Switch |
| 13 | gear box | 45 | handle clmap | 77 | Cable protector |
| 14 | screwM6*12 | 46 | NUT M6 | 78 | Cable |
| 15 | screwM5*25 | 47 | sponge tube | 79 | cable anchorage |
| 16 | pinion shaft | 48 | handle | 80 | Tapping screw ST4*14 |
| 17 | circlip \varnothing 10 | 49 | NUT M5 | 81 | switch trigger |
| 18 | circlip \varnothing 26 | 50 | strap hook ring | 82 | Tapping screw ST3*6 |
| 19 | soft shaft limit set | 51 | strap hook | 83 | cabel clamp |
| 20 | Retaining ring | 52 | screw M5*20 | 84 | screw M4*12 |
| 21 | soft shaft A | 53 | shoulder strap | 85 | housing |
| 22 | plastic tube A | 54 | output shaft | 86 | Tapping screw ST4*16 |
| 23 | guard press board | 55 | Woodruff key | 88 | hex wrench 4mm |
| 24 | screwM6*20 | 56 | screw ST4*16 | 89 | hex wrench 5mm |
| 25 | rivet \varnothing 4X6 | 57 | gear box cover | 90 | wrench |
| 26 | guard | 58 | bearing 6001Z | 91 | spool assembly |
| 27 | Tapping screw ST4*8 | 59 | bearing cover | 92 | spanner |
| 28 | blade | 60 | screw ST4*10 | 93 | Rubber plug |
| 29 | steel tube A | 61 | gear | 94 | Rubber plug |
| 30 | shrapnel | 62 | needle bearing HK0810 | 200 | Gearbox assembly |
| 31 | rivet | 63 | Tapping screw ST4*35 | | |
| 32 | connect tube | 64 | gear box | | |

нас рекомендуют друзьям

нас рекомендуют друзьям GT1600D-EX-RUS220908